

Girder Splice Bolt Replacement



Bulletin no. 13423-1

New: Dec. 13, 2004

Rev. 0



TECHNICAL DATA SHEET
Structural Inspection Program
P&H/Morris Cranes

Girder Splice Bolts

- P&H recommends replacement after 10 years of use for tension loaded bolts.
- Be sure to get a specifically designed bolt replacement procedure for your crane from P&H prior to replacing any girder splice bolts.
- Generally, if one bolt breaks, the adjacent bolts absorb higher stress and should also be suspect.
- For non-P&H cranes, P&H can review the design and provide improvements for the bolts and flanges.

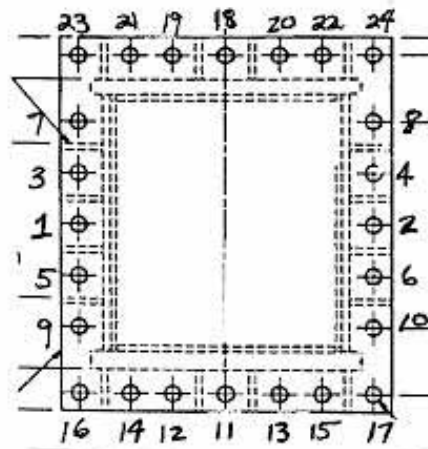

Typical bolt application sequence



For further details contact

Morris Material Handling
Phone 414-573-8082
www.morriscranes.com